

Wall Summary		
Load Bearing Walls	10	31500
Non Load Bearing Walls	7	19950
Support Beams	4	19200
Support Posts	5	

Wall Design Summary	
System Types Found	BestSteelAUST75
Wind Load Found (AS4055)	N3
Load Types Found	Sheet
Floor Types Found	Steel
Opening Library's Found	GJames

Opening Summary		
1012AW	[1050h x 1260w]	1
2118AD	[2125h x 1860w]	1
820Ed	[2130h x 890w]	1
0606AW	[650h x 660w]	2
770Pd	[2100h x 820w]	2
820Pd	[2100h x 870w]	2
1215AW	[1250h x 1560w]	4

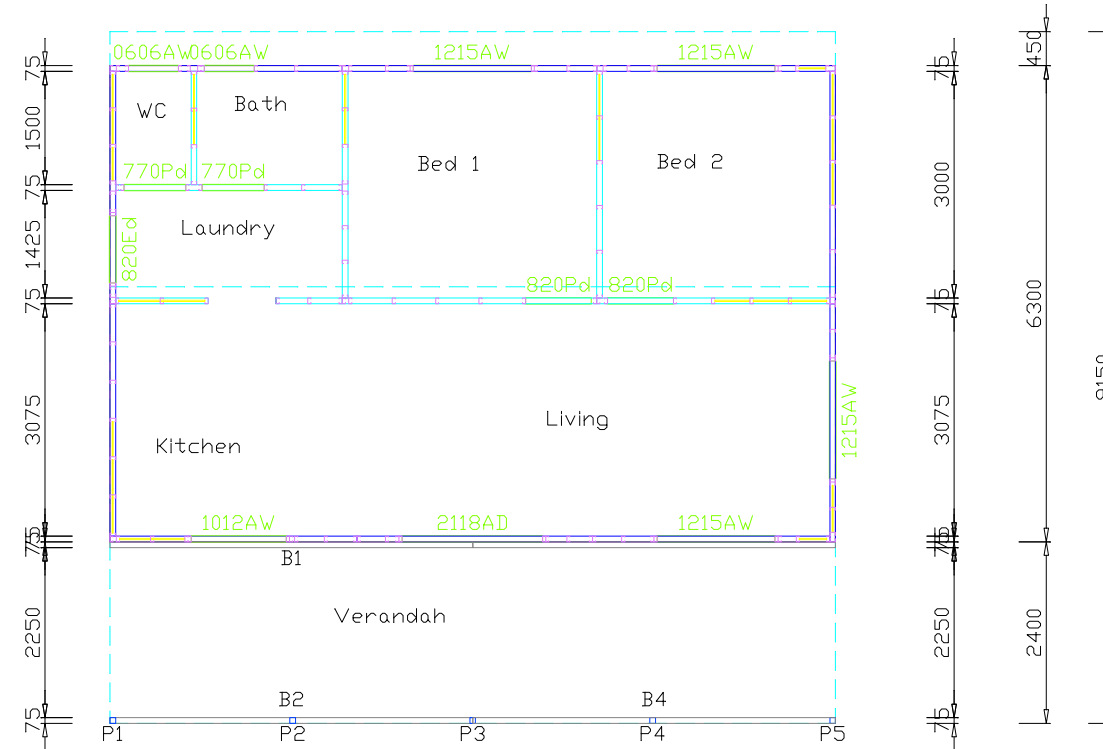
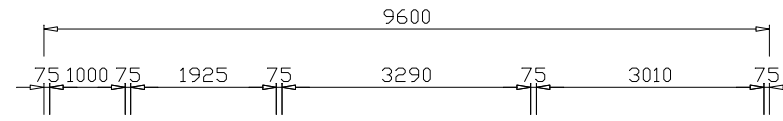

Beam Summary		
B1	N/CH 10019	4800
B2	N/CH 10019	4800
B3	N/CH 10019	4800
B4	N/CH 10019	4800
Total Weight (kg)		63.168

Post Summary		
P1	75x75x3SHS	2258
P2	75x75x3SHS	2258
P3	75x75x3SHS	2258
P4	75x75x3SHS	2258
P5	75x75x3SHS	2258
Total Weight (kg)		74.514



DATE DRAWN
20-08-2014

DWG FILE
The Currimundi

DRAWN
SH

CHECKED

VIEW NAME
2 of 5

SCALE
1:100

JOB DETAILS

The information contained within is intended to be an aid for fabricators and detailers and is not a substitute for professional judgement.

JOB REFERENCE
Currimudi

REVISION